

- Junct.
- Cross Section
- Brdg/Culv
- Inline Structure
- Lateral Structure
- Storage Area
- Storage Area Conn.
- Pump Station
- HTab Param.
- View Picture

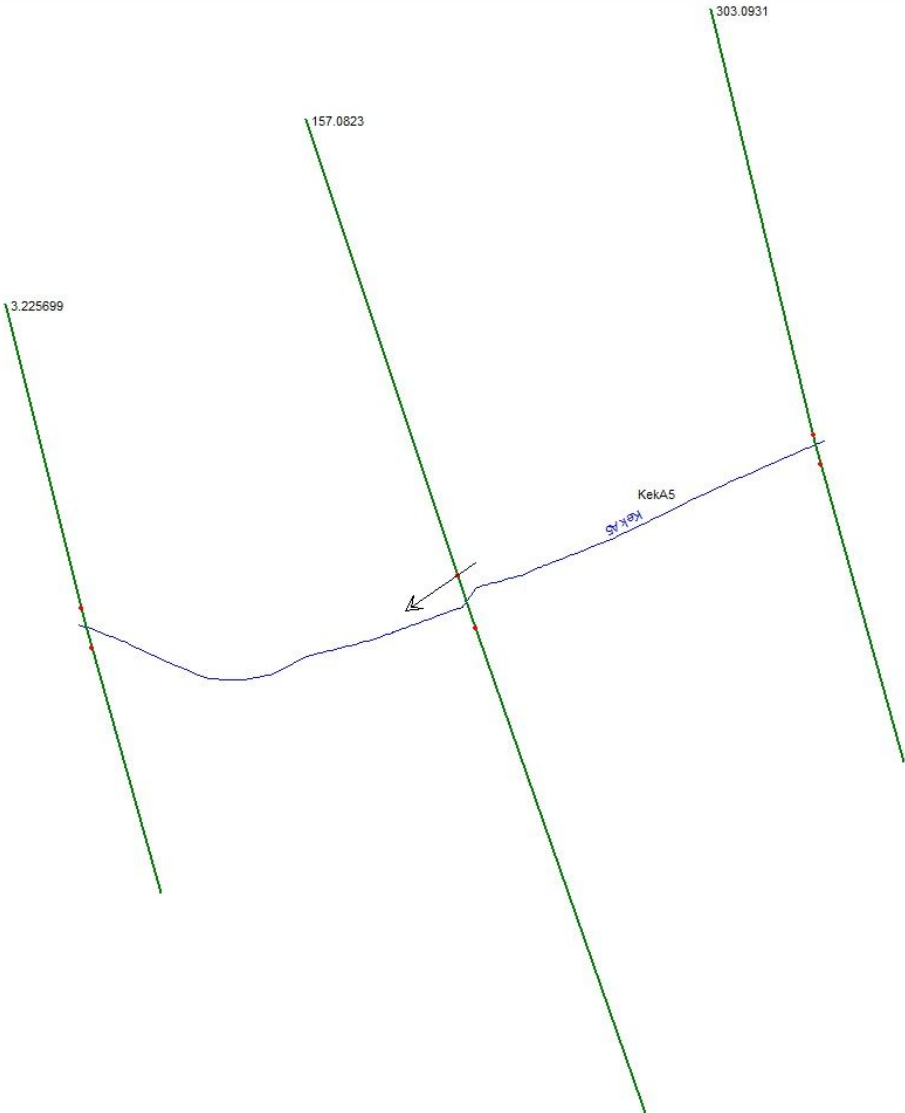

River: KekA5
 Reach: KekA5
 River Sta.: 3.225699

Cross Section Coordinates	
Station	Elevation
1	0
2	2.47
3	3.63
4	5.16
5	8.3
6	8.56
7	8.59
8	8.71
9	10.91
10	12.58
11	14.59
12	17.51
13	17.66
14	18
15	18.19
16	20.7
17	22.33
18	23.83
19	24.25
20	27.41
21	27.68
22	28.18
23	28.48
24	30.31
25	31.92
26	32.69
27	34.62
28	36.55
29	37.32
30	37.78
31	38.19
32	38.95
33	42.8
34	44.29
35	45.33
36	49.5
37	50.89
38	53.13
39	53.97
40	55.34
41	56.1
42	59.64
43	60.73
44	64.51
45	65.64
46	66.02
47	66.23
48	67.94
49	68.29
50	69.84
51	70.75
52	72.55
53	72.92

Downstream Reach Lengths		
LDB	Channel	ROB
0	3.23	0

Manning's n Values		
LDB	Channel	ROB
0.09	0.045	0.09

Main Channel Bank Stations	
Left Bank	Right Bank
118.7	134.45

Cont'n Exp Coefficient (Steady Flow)	
Contraction	Expansion
0.1	0.3

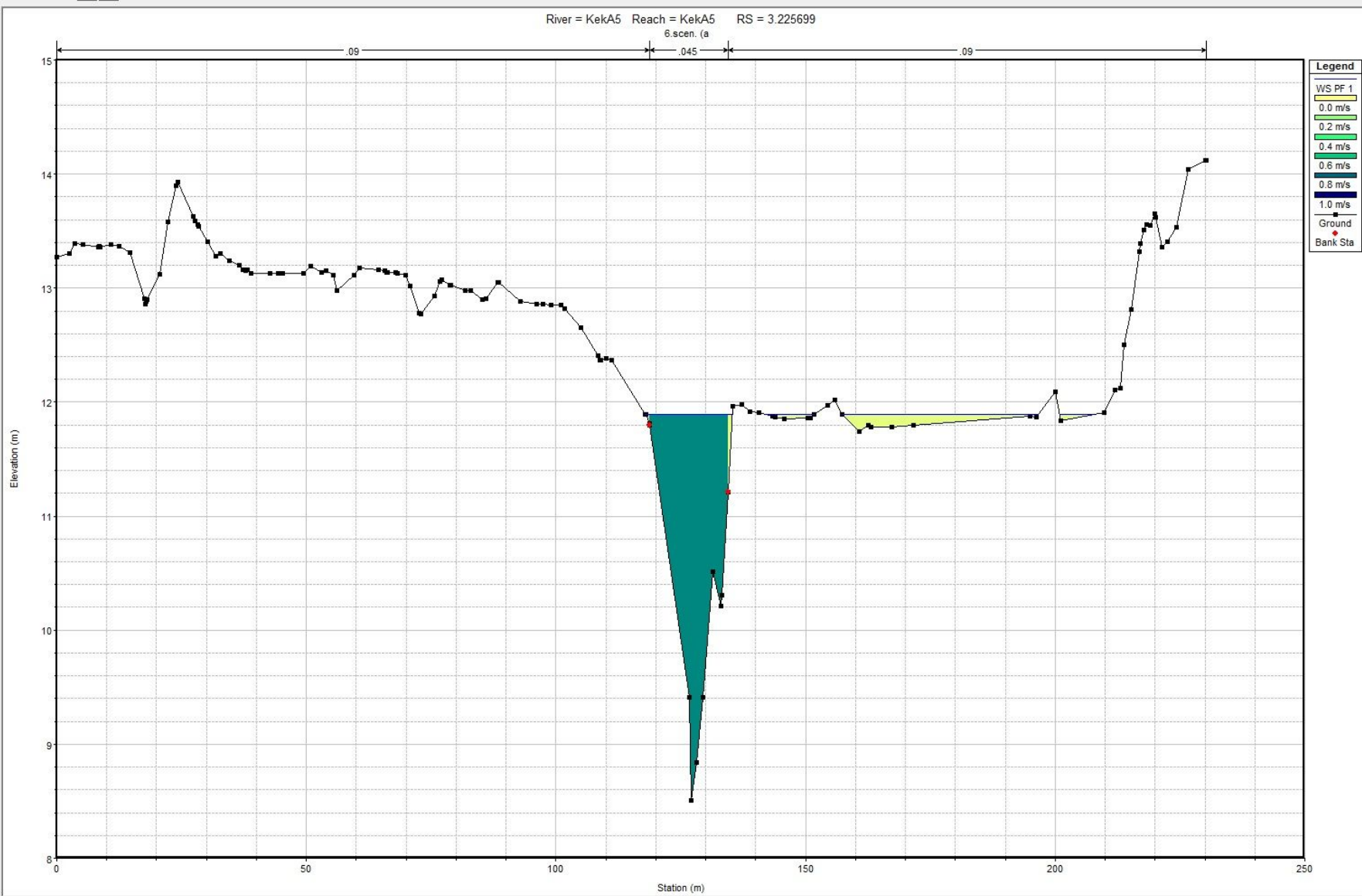

Select river station for cross section editing.

River: KekA5 Apply Data

Reach: KekA5 River Sta.: 157.0823

Description

Del Row Ins Row

Cross Section Coordinates

Station	Elevation
1 0	13.17
2 3.23	13.25
3 5.58	13.33
4 5.84	13.34
5 6.7	13.33
6 9.56	13.29
7 10.94	13.29
8 11.83	13.36
9 13.95	13.55
10 17.59	13.6
11 17.88	13.61
12 18.3	13.62
13 19.06	13.68
14 22.05	13.86
15 23.06	13.86
16 25.4	13.91
17 28.78	13.9
18 29.59	13.83
19 30.74	13.85
20 31.85	13.87
21 31.9	13.87
22 32.43	13.86
23 37.02	13.78
24 37.91	13.87
25 39.31	14.04
26 40.23	14.19
27 41.93	14.34
28 42.25	14.36
29 43.36	14.13
30 43.85	14.03
31 45.13	13.87
32 46.88	13.88
33 47.54	13.92
34 48.59	13.98
35 50.14	14.11
36 50.49	14.1
37 51.09	14.11
38 55.08	14.14
39 57.48	14.15
40 58.35	14.14
41 58.82	14.15
42 61.15	14.29
43 63.29	14.37
44 63.72	14.27
45 64.71	14.21
46 66.47	14.01
47 67.81	13.87
48 69.91	13.86
49 70.82	13.86
50 70.91	13.86
51 73.14	13.87
52 73.85	13.93
53 74.05	13.99

Downstream Reach Lengths

LOB	Channel	ROB
153.86	153.86	153.86

Manning's n Values

LOB	Channel	ROB
0.09	0.045	0.09

Main Channel Bank Stations

Left Bank	Right Bank
181.84	202.68

Contr. Exp Coefficient (Steady Flow)

Contraction	Expansion
0.1	0.3

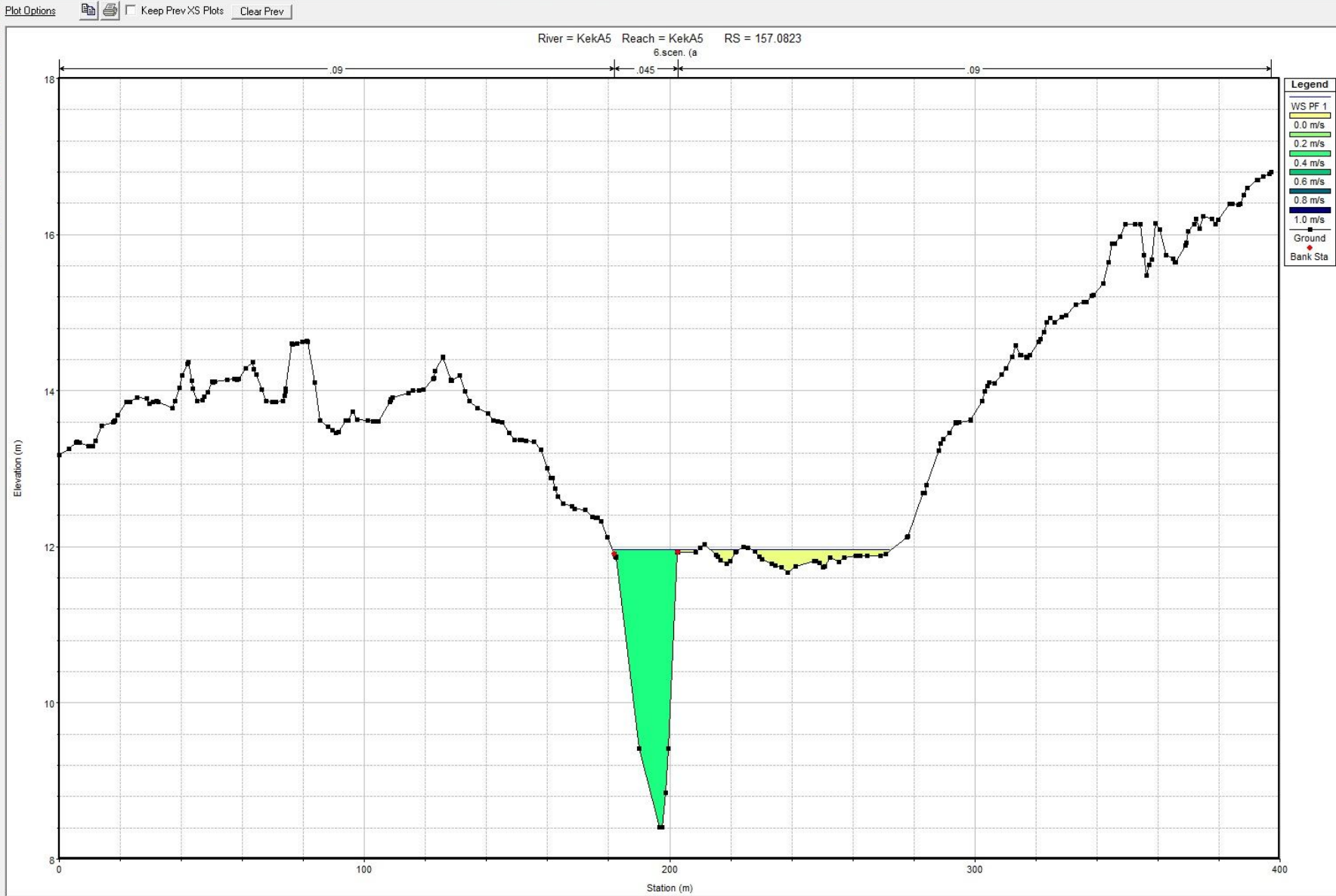

Enter to move to next upstream river station location

River: KekA5 Apply Data

Reach: KekA5 River Sta.: 303.0931

Description

Del Row Ins Row

Cross Section Coordinates

Station	Elevation
1 0	15.61
2 4.16	15.6
3 7.52	15.66
4 10.62	15.63
5 13.77	15.64
6 14.88	15.63
7 22.46	15.38
8 24.82	15.38
9 27	15.38
10 27.96	15.35
11 32.74	15.21
12 36.8	15.12
13 37.9	15.11
14 40.44	15.11
15 40.47	15.11
16 40.52	15.11
17 48.86	15.25
18 49.22	15.26
19 51.12	15
20 53.55	14.92
21 56.72	14.87
22 57.15	14.87
23 61.99	14.85
24 63.68	14.87
25 64.91	14.76
26 65.61	14.66
27 66.62	14.68
28 69.31	14.67
29 70.94	14.77
30 72.2	15.14
31 74.73	15.21
32 75.39	15.19
33 78.1	15.03
34 79	14.94
35 79.89	14.88
36 80.21	14.88
37 82.21	14.78
38 83.71	14.77
39 86.35	14.77
40 91	14.86
41 91.35	14.87
42 91.69	14.86
43 95.29	14.79
44 96.93	14.75
45 100.97	14.7
46 103.89	14.63
47 105.53	14.64
48 107.53	14.63
49 110.15	14.53
50 114.32	14.38
51 114.66	14.37
52 114.99	14.37
53 119.04	14.37

Downstream Reach Lengths		
LOB	Channel	ROB
146.01	146.01	146.01

Manning's n Values		
LOB	Channel	ROB
0.09	0.045	0.09

Main Channel Bank Stations	
Left Bank	Right Bank
165.84	177.06

Cont.Exp Coefficient (Steady Flow)	
Contraction	Expansion
0.1	0.3

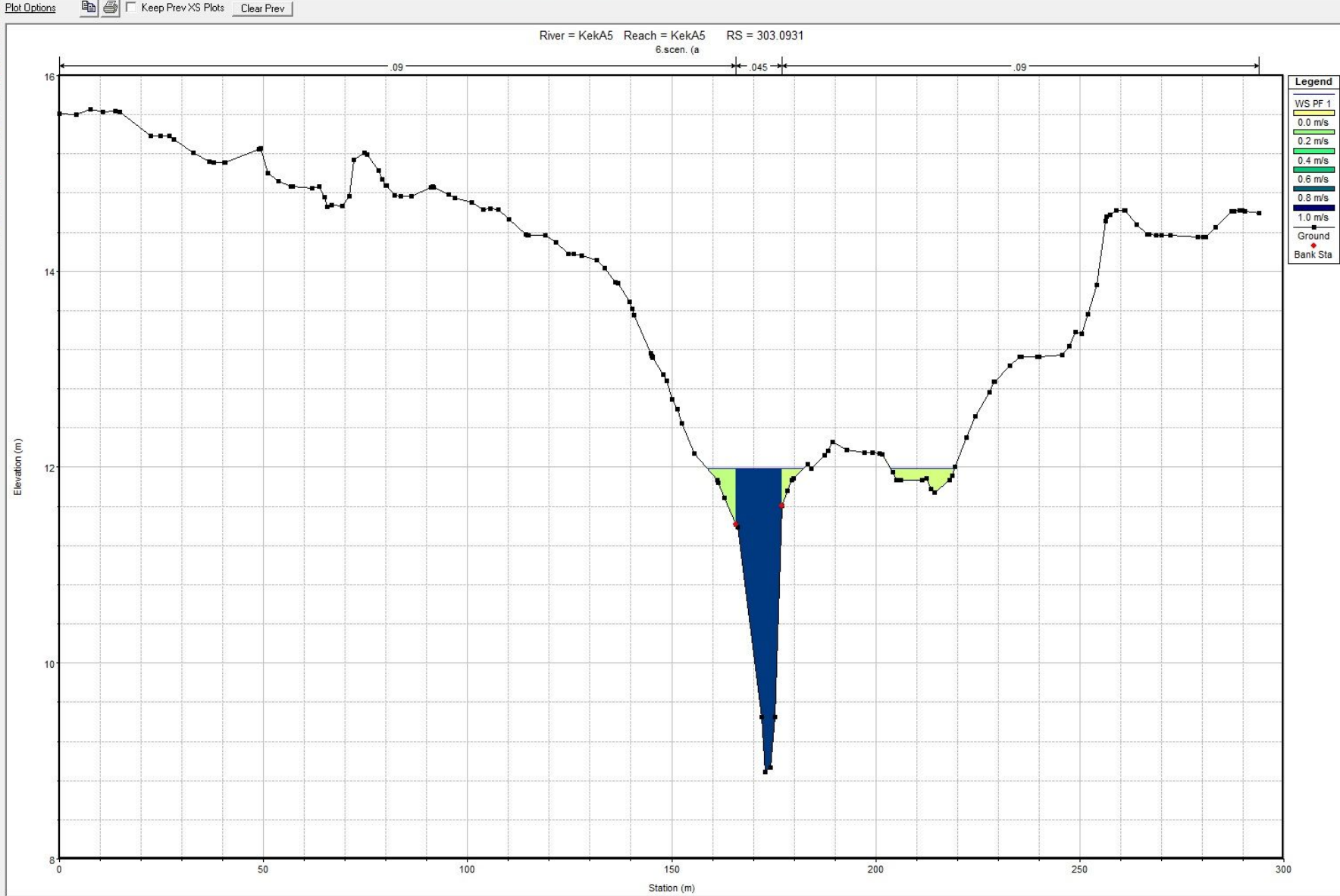

Enter to move to next upstream river station location

Enter/Edit Number of Profiles (25000 max):

Locations of Flow Data Changes

River:
 Reach: River Sta.:

Flow Change Location

Profile Names and Flow Rates

River	Reach	RS	PF 1
1 KekA5	KekA5	303.0931	19.56

Steady Flow Boundary Conditions

Set boundary for all profiles
 Set boundary for one profile at a time

Available External Boundary Condition Types

Selected Boundary Condition Locations and Types

River	Reach	Profile	Upstream	Downstream
KekA5	KekA5	all		Normal Depth S = 0.00064

Enter to accept data changes.